



# Chromebox OPS OPx1-3

## User's Manual



# TABLE OF CONTENTS

|   |           |
|---|-----------|
| <b>SAFETY .....</b>   | <b>4</b>  |
| <i>Engineering Conditions of Acceptability .....</i>                | <i>4</i>  |
| <i>Battery notices .....</i>  | <i>4</i>  |
| <i>Products incorporating button or coin cell batteries .....</i>   | <i>5</i>  |
| <b>COPYRIGHT .....</b>  | <b>6</b>  |
| <b>REGULATORY STATEMENT .....</b>                                   | <b>7</b>  |
| <i>Federal Communication Commission (FCC) Statement .....</i>       | <i>7</i>  |
| <i>FCC RF Radiation Exposure Statement .....</i>                    | <i>8</i>  |
| <i>EU &amp; UKCA Regulatory Conformance and Documentation .....</i> | <i>8</i>  |
| <i>EU Regulatory Compliance.....</i>                                | <i>8</i>  |
| <i>UK Regulatory Compliance .....</i>                               | <i>8</i>  |
| <i>Restriction of Hazardous Substances (RoHS) Directive.....</i>    | <i>9</i>  |
| <b>PRODUCT OVERVIEW .....</b>                                       | <b>10</b> |
| <i>Package contents .....</i>                                       | <i>10</i> |
| <i>Front view .....</i>   | <i>11</i> |
| <i>Rear View .....</i>  | <i>11</i> |
| <i>Status indicators .....</i>                                      | <i>12</i> |
| <i>Specifications .....</i>   | <i>13</i> |
| <b>GETTING STARTED .....</b>  | <b>15</b> |
| <i>Connecting antennas .....</i>                                    | <i>15</i> |
| <i>Mounting the Chromebox.....</i>                                  | <i>16</i> |
| <i>Chromebox dimensions .....</i>                                   | <i>17</i> |
| <i>Connecting a display device .....</i>                            | <i>18</i> |
| <i>Connecting a mouse and keyboard .....</i>                        | <i>19</i> |
| <i>Connecting a wired mouse and keyboard .....</i>                  | <i>19</i> |
| <i>Connecting a wireless mouse and keyboard .....</i>               | <i>20</i> |

*Performing additional connections* .....21

*Connecting audio components*..... 21

*Connecting to local area network (LAN)*..... 21

*Connecting USB devices*..... 22

*Powering on your Chromebox*.....23

**FREQUENTLY ASKED QUESTIONS..... 24**

# SAFETY

When using this Chromebox, basic safety precautions should always be followed to reduce the risk of fire, electric shock and injury to persons, including the following:

- Do not place the device on an uneven or unstable surface.
- Do not use this device near water.
- Do not spill water or other liquids into or on the device.
- The device may produce some heat during normal operation. If you feel the device is too warm, avoid sustained contact with exposed skin otherwise this might cause discomfort, or eventually a burn.
- Clean only with a soft cloth. If needed, dampen the cloth slightly before cleaning. Never use abrasives or cleaning solutions.
- Always disconnect the device from an electrical outlet and power off before cleaning the device.
- Refer all servicing to qualified service personnel. Servicing is required when the device has been damaged in any way such as:
  - Docking connector is damaged.
  - Liquid has been spilled into the device.
  - The device has been exposed to rain or moisture.
  - The device does not operate normally.
  - The device was dropped or the chassis is damaged.

## Engineering Conditions of Acceptability

- The following end-product enclosures are required: Fire
- The end product should evaluate all likely positions of the equipment's orientation during installation and take opening requirements into account.

## Battery notices



### WARNING!



- *Risk of explosion if battery is replaced by an incorrect type. Dispose of used batteries according to the instructions.*
- *Leaving a battery in an extremely high temperature surrounding environment can result in an explosion or the leakage of flammable liquid or gas.*
- *A battery subjected to extremely low air pressure may result in an explosion or the leakage of flammable liquid or gas.*

## Products incorporating button or coin cell batteries



Instructions and manuals, if provided, shall include all of the applicable markings in figures “Packing marking - Warning: Contains coin battery” or “Packing marking - Warning of ingestion hazard” and the statements noted below. If instructions and manuals are not provided, the statements shall be present on the principal display panel or secondary display panel of the consumer product packaging, or if there is no consumer product packaging, the accompanying hang tag or sticker label.

- a) The statement “Remove and immediately recycle or dispose of used batteries according to local regulations and keep away from children. Do NOT dispose of batteries in household trash or incinerate.”
- b) The statement “Even used batteries may cause severe injury or death.”
- c) The statement “Call a local poison control center for treatment information.”
- d) A statement indicating the compatible battery type ML1220.
- e) The nominal battery voltage is 3V.
- f) The statement “Non-rechargeable batteries are not to be recharged.”
- g) The statement “Do not force discharge, recharge, disassemble, heat above (manufacturer’s specified temperature rating) or incinerate. Doing so may result in injury due to venting, leakage or explosion resulting in chemical burns.”

## Packing marking - Warning: Contains coin battery

|  <b>WARNING</b>  |   |
|---|---|
| <ul style="list-style-type: none"><li>• <b>INGESTION HAZARD:</b> This product contains a button cell or coin battery.</li><li>• <b>DEATH</b> or serious injury can occur if ingested.</li><li>• A swallowed button cell or coin battery can cause <b>Internal Chemical Burns</b> in as little as <b>2 hours</b>.</li><li>• <b>KEEP</b> new and used batteries <b>OUT OF REACH</b> of <b>CHILDREN</b></li><li>• <b>Seek immediate medical attention</b> if a battery is suspected to be swallowed or inserted inside any part of the body.</li></ul> |  |

## Packing marking - Warning of ingestion hazard

|  <b>WARNING</b>  |  |
|---|--|
| <ul style="list-style-type: none"><li>• <b>INGESTION HAZARD:</b> This product contains a button cell or coin battery.</li><li>• <b>DEATH</b> or serious injury can occur if ingested.</li><li>• A swallowed button cell or coin battery can cause <b>Internal Chemical Burns</b> in as little as <b>2 hours</b>.</li><li>• <b>KEEP</b> new and used batteries <b>OUT OF REACH</b> of <b>CHILDREN</b></li><li>• <b>Seek immediate medical attention</b> if a battery is suspected to be swallowed or inserted inside any part of the body.</li></ul> |  |

The product contains non-replaceable button/coin cell battery ML1220.

## COPYRIGHT

Wi-Fi and the Wi-Fi CERTIFIED logo are registered trademarks of the Wireless Fidelity Alliance.

All products use in this device and trademarks mentioned herein are trademarks or registered trademarks of their respective owners.

© Copyright 2024

## Federal Communication Commission (FCC) Statement

This device complies with Part 15 of the FCC Rules. Operation is subject to the following two conditions:

- (1) this device may not cause harmful interference that may cause undesired operation.
- (2) this device must accept any interference received, including interference that may cause undesired operation.

**Caution:** The user is cautioned that changes or modifications not expressly approved by the party responsible for compliance could void the user's authority to operate the equipment.

**Note:** This equipment has been tested and found to comply with the limits for a Class B digital device, pursuant to part 15 of the FCC Rules.

These limits are designed to provide reasonable protection against harmful interference in a residential installation. This equipment generates uses and can radiate radio frequency energy and, if not installed and used in accordance with the instructions, may cause harmful interference to radio communications. However, there is no guarantee that interference will not occur in a particular installation. If this equipment does cause harmful interference to radio or television reception, which can be determined by turning the equipment off and on, the user is encouraged to try to correct the interference by one or more of the following measures:

- Reorient or relocate the receiving antenna.
- Increase the separation between the equipment and receiver.
- Connect the equipment into an outlet on a circuit different from that to which the receiver is connected.
- Consult the dealer or an experienced radio/TV technician for help.

## FCC RF Radiation Exposure Statement



This equipment complies with FCC radiation exposure limits set forth for an uncontrolled environment. This equipment should be installed and operated with minimum distance 20cm between the radiator & your body. This transmitter must not be co-located or operated with any other antenna or transmitter.

Cet équipement est conforme aux limites d'exposition aux rayonnements FCC établies pour un environnement non contrôlé. Cet équipement doit être installé et utilisé à une distance minimale de 20 cm entre le radiateur et votre corps. Cet émetteur ne doit pas être situé ou utilisé avec une autre antenne ou un autre émetteur.

## EU & UKCA Regulatory Conformance and Documentation



### EU Regulatory Compliance

Hereby, Quanta Computer Inc. declares that this device is in compliance with the following Directive: RED 2014/53/EU, RoHS 2011/65/EU, ErP 2009/125/EC.

### UK Regulatory Compliance

Hereby, Quanta Computer Inc. declares that this device is in compliance with the following Regulations: Radio Equipment Regulations 2017, The Restriction of the Use of Certain Hazardous Substances in Electrical and Electronic Equipment Regulations 2012, The Ecodesign for Energy-Related Products Regulations 2010.



## **Restriction of Hazardous Substances (RoHS) Directive**

This Quanta Computer Inc. product, with included parts (cables, cords, and so on) meets the requirements of Directive 2011/65/EU on the restriction of the use of certain hazardous substances in electrical and electronic equipment.

# PRODUCT OVERVIEW

## Package contents

Please take a moment to check if all the necessary items are included in the package. If anything is missing or damaged, please contact your dealer immediately.

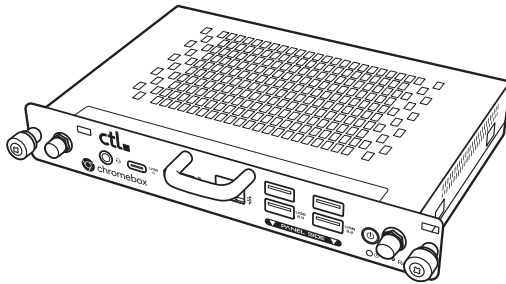

- 
- **Chromebox**
- 



- 
- **Antennas x2**
-

# Front view

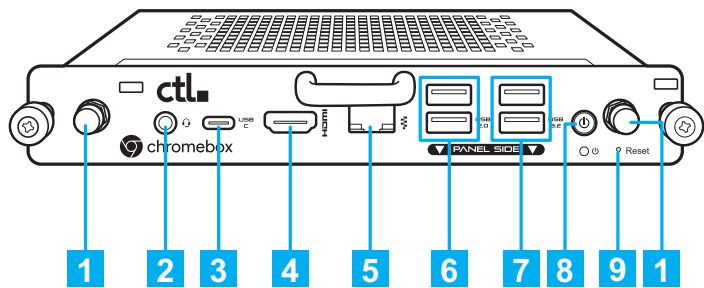

| No. | Description        | No. | Description         |
|-----|--------------------|-----|---------------------|
| 1   | Antenna port       | 6   | (2) USB-A 2.0 ports |
| 2   | Audio jack (3.5mm) | 7   | (2) USB-A 3.2 ports |
| 3   | USB Type-C port    | 8   | Power button        |
| 4   | HDMI 2.0 port      | 9   | Reset hole          |
| 5   | LAN port           |     |                     |

# Rear View

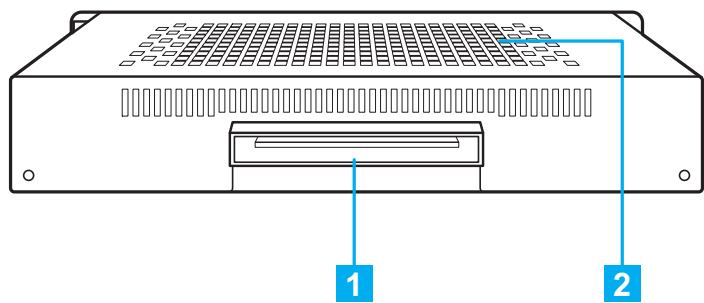

| No. | Description       | No. | Description    |
|-----|-------------------|-----|----------------|
| 1   | Docking connector | 2   | Thermal outlet |



# Specifications

| Item              | Description  |
|-------------------|--|
| <b>System</b>     |  |
| Platform          | Alder Lake-U15 or Raptor Lake-U15 Chromebox  |
| Processor type    | <ul style="list-style-type: none"><li>• Intel Celeron 7305E 5C 1.0G BGA 8 MB 15W (Alder Lake-U15)</li><li>• Intel Celeron 7305 5C 1.10G BGA 8 MB 15W (Alder Lake-U15)</li><li>• Intel Core i3-1315U 1.20G 10 MB 6C 15W CPU (Raptor Lake-U15)</li><li>• Intel Core i5-1335U 1.30G 12 MB 10C 15W CPU (Raptor Lake-U15)</li><li>• Intel Core i5-1345U 1.60G 12 MB 10C 15W CPU (Raptor Lake-U15)</li><li>• Intel Core i7-1355U 10C 1.80G 12 MB 15W CPU (Raptor Lake-U15)</li></ul> |
| Graphics          | <ul style="list-style-type: none"><li>• Intel® UHD Graphics</li><li>• Intel Iris Xe Graphics-with shared video memory</li></ul>  |
| Integrated audio  | HD audio   |
| Memory            | SODIMM (DDR4-3200) DDR-4 module <ul style="list-style-type: none"><li>• 8GB/16GB/32GB</li></ul>  |
| Storage           | SSD 256GB/512GB/1TB 2230/2280 type   |
| Operating system  | ChromeOS   |
| <b>Connectors</b> |  |
| Front             | <ul style="list-style-type: none"><li>• Combo Jack</li><li>• USB 3.2 Gen1(5Gbps) x2</li><li>• USB 2.0 x2</li><li>• USB Type-C (without plug-in power on support)</li><li>• RJ45 with LEDs for Gigabit LAN</li><li>• HDMI 2.0</li><li>• Recover button</li><li>• Antennas x2</li><li>• Power LED indicator</li><li>• Handle bar</li></ul>   |
| Rear              | Docking connector for connecting with TV   |

| Item                                     | Description   |
|--|---|
| <b>Dimensions</b>                        |   |
| L x H x W (mm)                           | 200 x 119 x 30 mm   |
| <b>Wireless and networking</b>           |   |
| LAN support                              | Gigabit Ethernet with speed up to 10/100/1000M GbE            |
| WLAN and Bluetooth support               | M.2 2230 Intel Wifi6E + BT 5.2 Garfield Peak 2 AX211 non-vPro |
| <b>Power source</b>                      |   |
| Power supply from the Chromebox monitor. |   |

» **NOTE:** The Chromebox does not support hot-plug operation.

# GETTING STARTED

## Connecting antennas

For wireless connectivity, secure two antennas to the front of the Chromebox.

1. Remove the rubber caps from the antenna connectors.

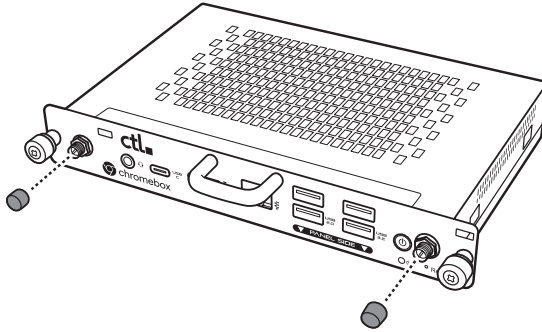

2. Firmly tighten the antennas to the connectors.

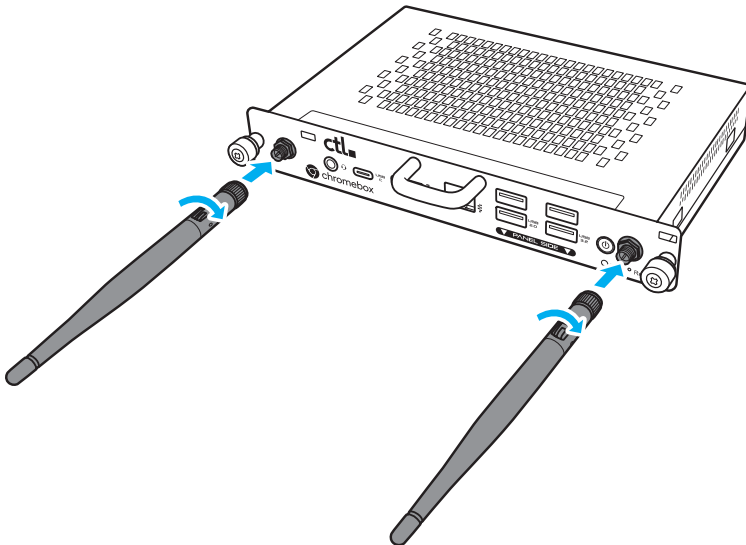

## Mounting the Chromebox

1. Insert the Chromebox into the OPS slot in your TV. Push on the module firmly until it is flush with the surface of the slot.
2. Secure the Chromebox to your TV by tightening the thumb screws.

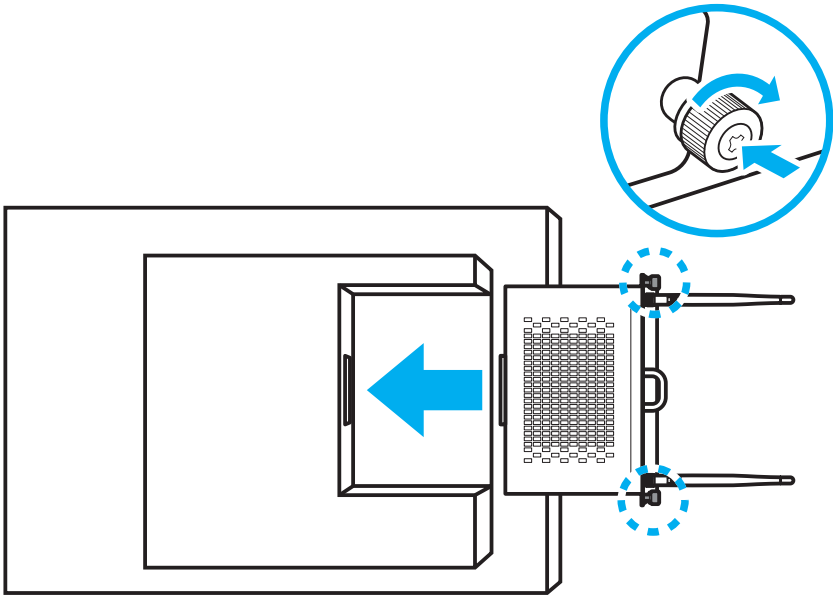



## Chromebox dimensions

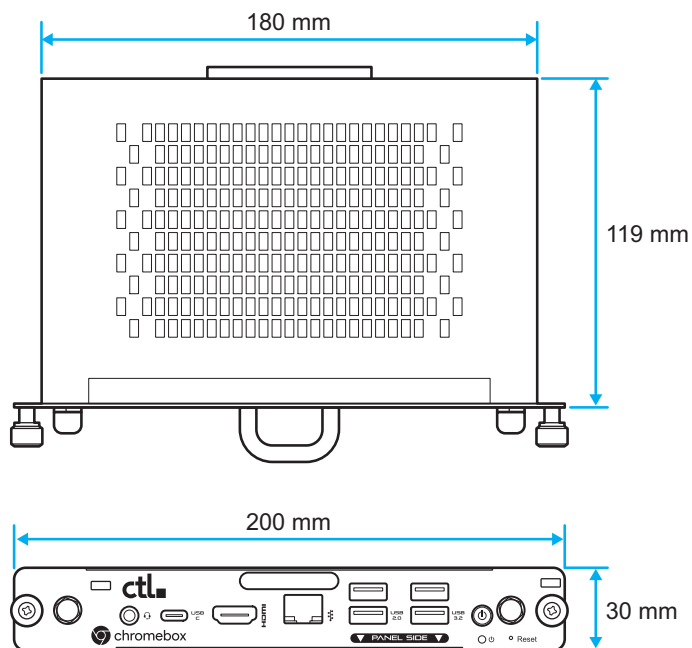

## Connecting a display device

To establish the connection, you need to use an HDMI cable (not supplied).

1. Connect one end of the HDMI cable to the HDMI port of your Chromebox.
2. Connect the other end of the HDMI cable to the HDMI port of your display device.

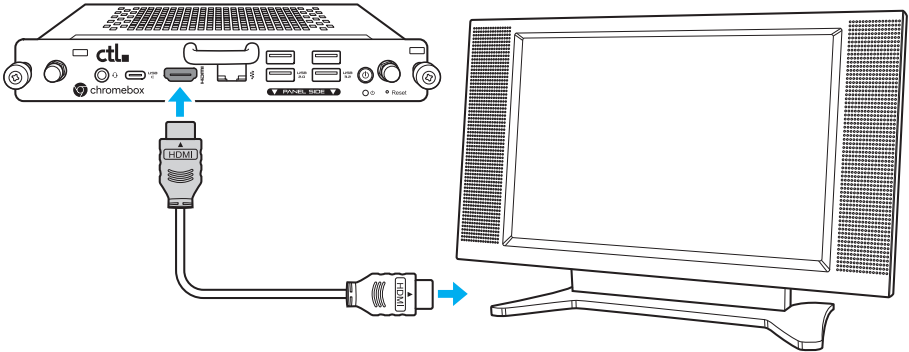

The terms HDMI, HDMI High-Definition Multimedia Interface, HDMI trade dress and the HDMI Logos are trademarks or registered trademarks of HDMI Licensing Administrator, Inc.

## Connecting a mouse and keyboard

Your Chromebox supports both wired and wireless mouse and keyboard.

## Connecting a wired mouse and keyboard

Connect the USB mouse and USB keyboard to the USB ports of your Chromebox.

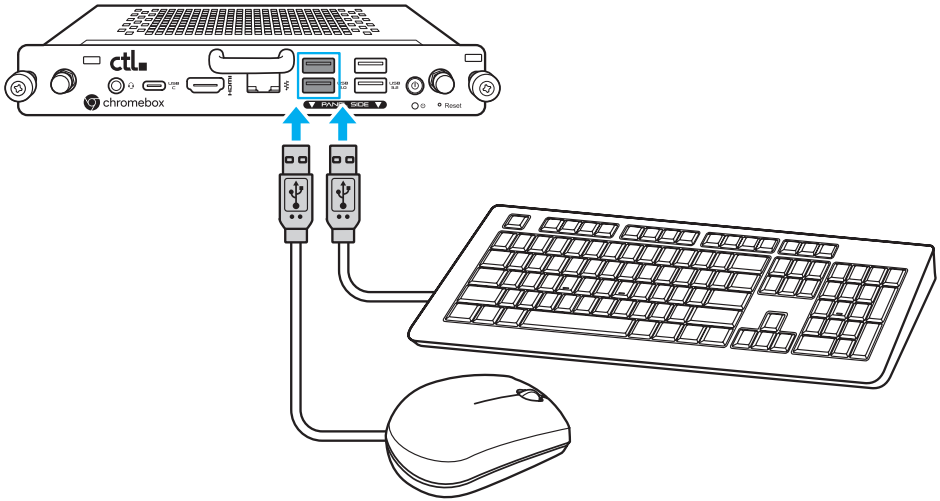

## Connecting a wireless mouse and keyboard

Connect the USB receiver that is supplied with your wireless mouse and keyboard to the USB port of your Chromebox.

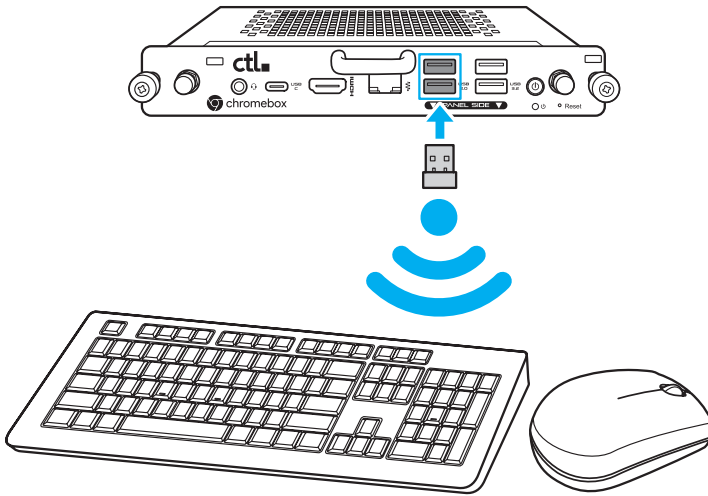

» **NOTE:** After you power on the Chromebox, the wireless mouse and keyboard are usually paired automatically. If any additional steps are required, please refer to the manual that came with your accessories.

# Performing additional connections

## Connecting audio components

Connect the audio component into the audio jack of your Chromebox.

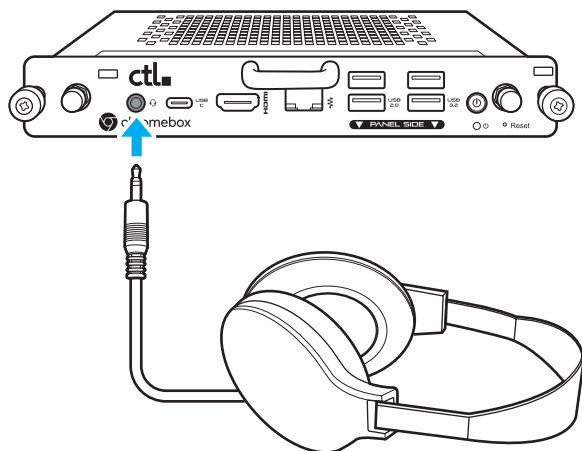

## Connecting to local area network (LAN)

1. Connect one end of the RJ45 cable to the LAN port of your Chromebox.
2. Connect the other end of the RJ45 cable to a network connection device or a network wall connector.

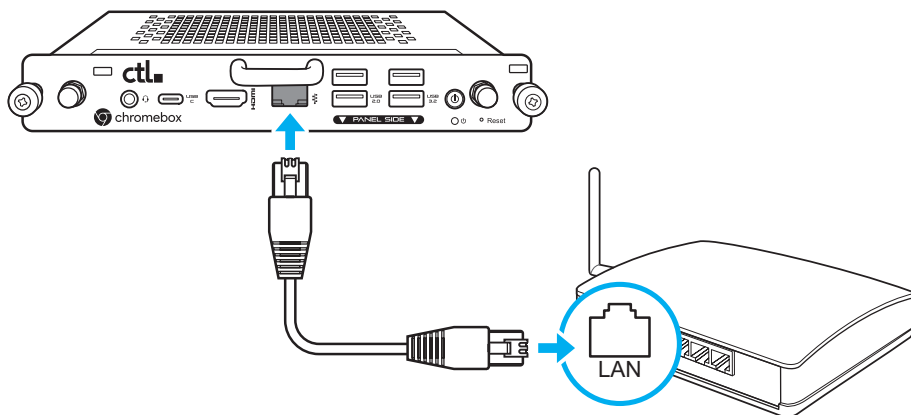

## Connecting USB devices

» **NOTE:** Your Chromebox supports USB-A 2.0, USB-A 3.2 Gen1, and USB-C.

Depending on the supported USB type, connect the USB device to the respective USB port of your Chromebox.

- USB-A 3.2 compatible device connect to one of the following USB ports:

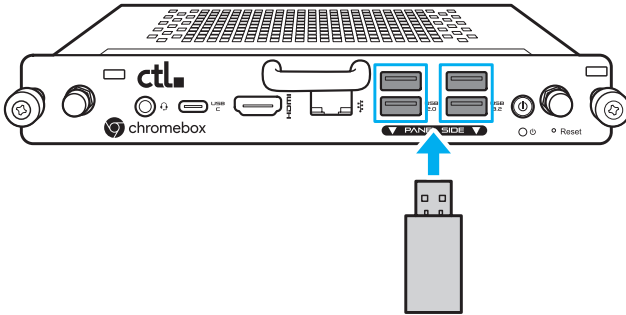

- USB-C compatible device connect to the following USB port:

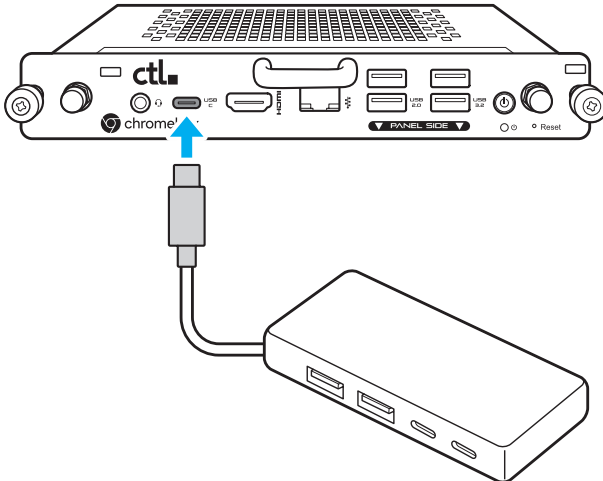

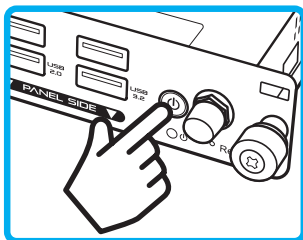

## Powering on your Chromebox

To power on your Chromebox, press the **Power** button on the front panel. The **Power** button LED lights solid blue.



After you power on the Chromebox for the first time, you are prompted to configure some device's basic settings, such as set the language, configure accessibility options, connect to the network, and finally sign in to your Google account. Follow the on-screen instructions to complete the initial setup.

# FREQUENTLY ASKED QUESTIONS

| Question  | Solution  |
|---|---|
| What software works on a Chromebox?                       | Chromeboxes use apps from the Google Play Store and on the web. There are apps to be productive, get creative, enjoy movies and shows, play games and more.   |
| How do I get more apps?                                   | You can get more apps from the Google Play Store  or the web.  |
| Can I use Microsoft Office software?                      | Chromeboxes work with Microsoft® Office. Whether it's Word, Excel® or PowerPoint®, you can easily find the apps on the web.   |
| Where can I find my files?                                | All your files are stored in the Files app  . Find the app by clicking the Launcher icon  and searching "Files".  |
| How do I transfer my local files?                         | <p>Transfer your local files using a compatible storage device. Your Chromebox works with most external storage devices (e.g.: USB thumb drives, removable hard drives).</p> <p>You can also upload your files, photos, and videos to Google Drive. After setting up your Chromebox with your Google Account, you'll be able to access your files on Drive.</p> |
| Why does my Chromebox need my Google Account information? | You'll use your Google Account to sign in to your Chromebox. It is the same account you use for Google services such as Gmail and Drive. Your Chromebox uses your account information to automatically sign you into apps and services.   |
| How do I set this up for my child?                        | If you want to set up parental controls for your child, it's important that you sign in using your child's personal Google Account. If they don't already have one, you can create one during the sign-in process on your Chromebox. You will be able to add your child's school account after you complete device onboarding.                                  |

## Get help or more information:



Visit [google.com/support/chromebook/](https://google.com/support/chromebook/)

Open the Explore app  on your Chromebox